

Mechanical Features		Electric Features	
General		General	
Working Moment	343.22 kgcm	Nominal Voltage	Δ : 230 V Y : 400 V
Unbalance	171.61 kgcm	Input Power	2.5 kW
FC	4312 kg	Current A Max	Δ : 9.92 A Y : 5.7 A
Bearings		Power factor	0.72
TYPE (SKF)	NJ 2311	la/ln	7
Life(h)	100%: 13635 80%: 28687 50%: >100000	Certification	
Bearing Grease		ETL CLASS II DIV.II GROUP F,G TENV NEMA 4	T4
Lube Schedule (g)	26	ATEX II 3D Ex tc IIIC Tx IP66	T 135°
Lube Replacement (g)	52	Amb Temp.	-20 ≤ T°C ≤ + 40
Grease Type	SKF LGHP2		

Dimensional Features (mm)

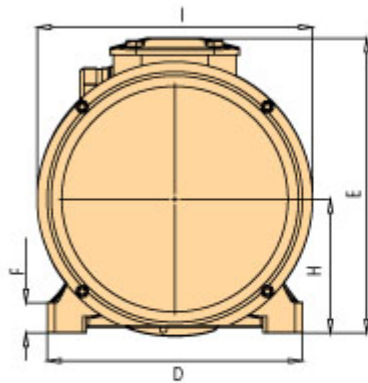
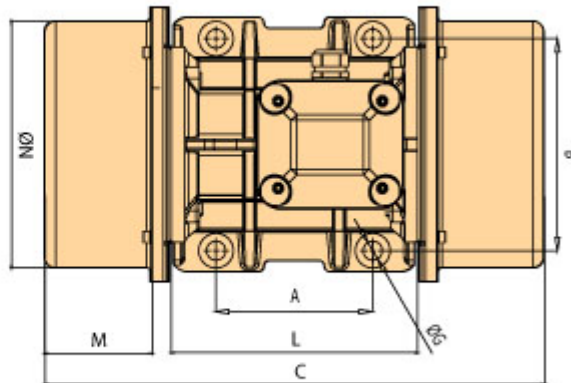

Fig. D



A	155
B	255
C	588
M	140
G	23.5
holes	4
D	302
E	318
F	35
H	147
I	295
L	273
N	264

Clamping Torque(Nm)

550

Weight(kg)	Screw	Washer	Cable Type	Cable Glande
134.4	M22	23x39	4Gx6	M32x1,5