

Mechanical Features		Electric Features	
General		General	
Working Moment	31.26 kgcm	Nominal Voltage	Δ : 230 V Y : 400 V
Unbalance	15.63 kgcm	Input Power	1.57 kW
FC	1601 kg	Current A Max	Δ : 5.12 A Y : 2.94 A
Bearings		Power factor	0.78
TYPE (SKF)	NJ 2308	la/ln	5,9
	100% 26197	Certification	
Life(h)	80%: 55118	ETL CLASS II DIV.II GROUP F,G TENV NEMA 4	T4
	50%: >100000	ATEX II 3D Ex tc IIIC Tx IP66	T 135°
Bearing Grease		Amb Temp.	-20 ≤ T°C ≤ + 40
Lube Schedule (g)	15		
Lube Replacement (g)	30		
Grease Type	SKF LGHP2		

Dimensional Features (mm)

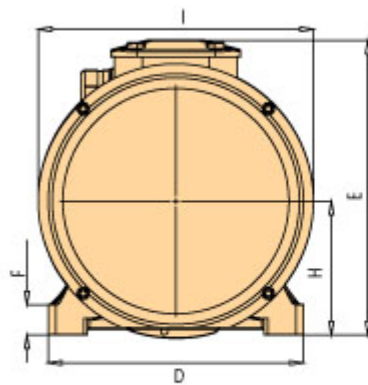
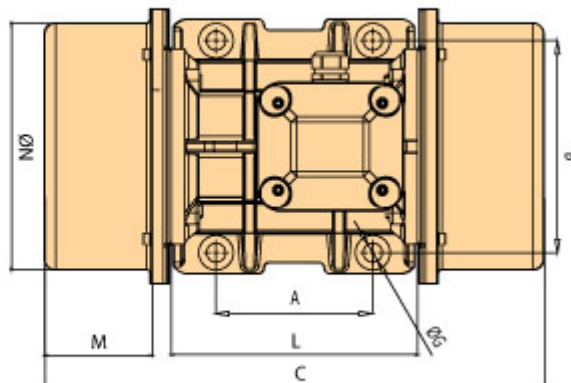

Fig. D



A	140
B	190
C	418
M	83
G	17
holes	4
D	229
E	262
F	30
H	120
I	247
L	220
N	222

Clamping Torque(Nm)

185

Weight(kg)	Screw	Washer	Cable Type	Cable Glande
51.6	M16	17x30	4Gx4	M25x1,5